

WINCH ASSEMBLY DRAWING (T1000-100/T1000-145)

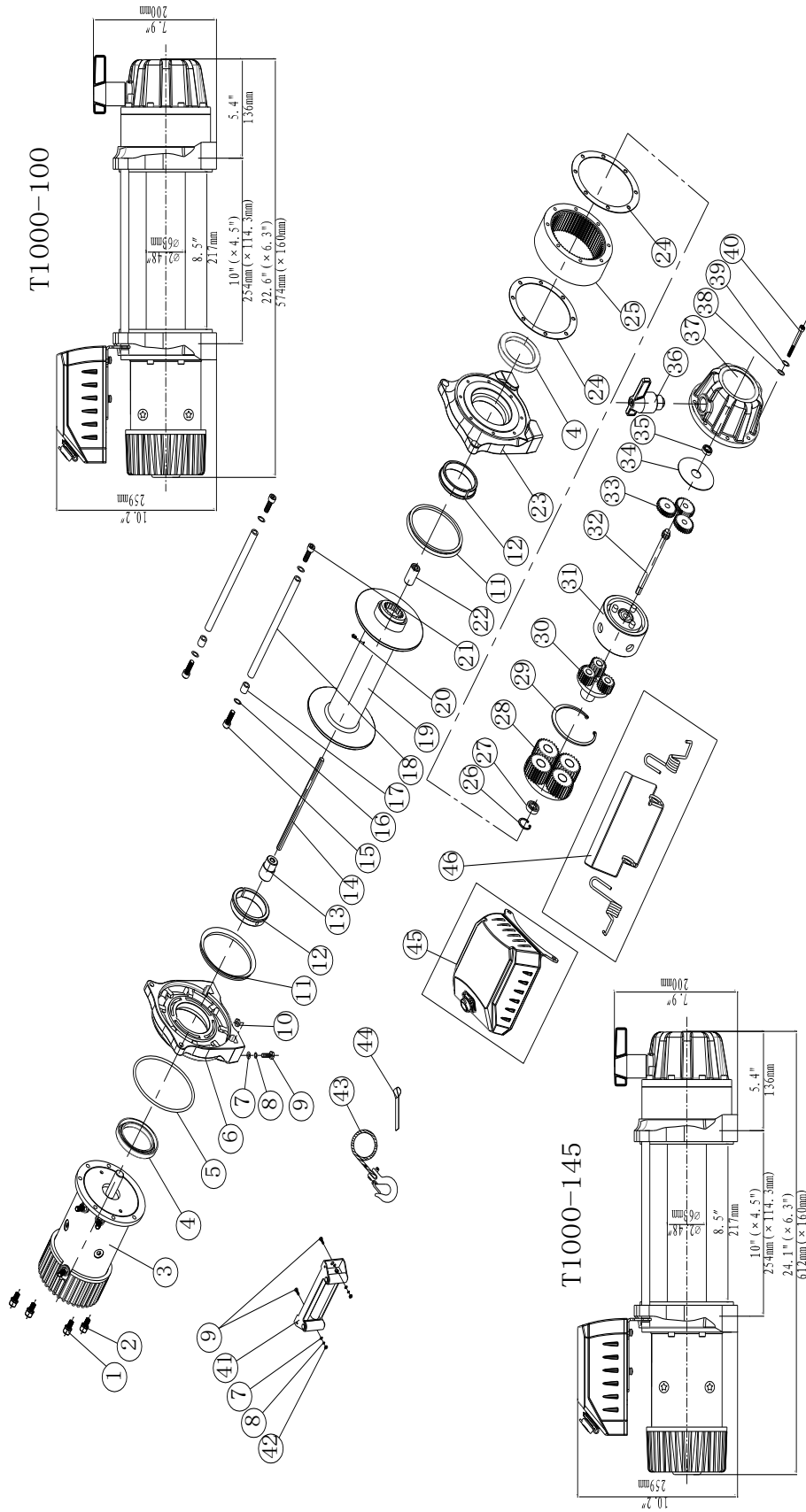

WINCH PARTS LIST (T1000-100/T1000-145)

No.	Part #	Qty	Description	Remark
1	T1000001	4	Lock Washer Φ6	
2	T1000002	4	Screw M6x 20	
3	T1000100	1	Motor Assembly	T1000-100
	T1450100			T1000-145
4	T1000003	2	Ring Seals	
5	T1000004	1	Ring Seals	
6	T1000005	1	Motor Bracket	
7	T1000006	6	Think Flat Washer Φ10	
8	T1000007	6	Lock Washer Φ10	
9	T1000008	6	Cap Screw M10 x 35	
10	T1000009	4	Hex Nut M10	
11	T1000010	2	Ring Seals	
12	T1000011	2	Bushing-Drum	
13	T1000012	1	Coupling	
14	T1000013	1	Six Angle Bar	
15	T1000014	2	Screw M8 x 35	
16	T1000015	4	Lock Washer Φ8	
17	T1000016	2	Spacer bush	
18	T1000017	2	Tie Bar	
19	T1000200	1	Drum Assembly	
20	T1000018	1	Screw M8×10	
21	T1000019	2	Screw M8 x 20	
22	T1000020	1	Coupling	
23	T1000021	1	End Bearing	
24	T1000022	2	Gasket	
25	T1000023	1	Gear—Ring	
26	T1000024	1	Circlip For Hole	
27	T1000300	1	Bearing	
28	T1000400	1	Gear Carrier Assembly (Output)	
29	T1000025	1	Circlip For Hole	
30	T1000500	1	Gear Carrier Assembly (Intermediate)	
31	T1000600	1	Brake/ Shaft Assembly	
32	T1000026	1	Gear—Input Sun	
33	T1000027	3	Planetary Gear	
34	T1000028	1	Trust Washer	
35	T1000700	1	Bearing	
36	T1000800	1	Clutch Assembly	
37	T1000029	1	Gear—Housing	
38	T1000030	8	Think Flat Washer Φ6	
39	T1000001	8	Lock Washer Φ6	
40	T1000031	8	Screw M6x 70	
41	T1000900	1	Roller Fairlead	
42	T1000032	2	Locknut M10	
43	T1001000	1	Cable Assembly	T1000-100
	T1451000			T1000-145
44	T1000033	1	Strap	
45	T1001100	1	Control Assembly	
46	T1001200	1	Tensioned Of Steel Wire Supplied Assembly	